

Racor Doble Anillo Trale LOK

Uniones tubo-tubo

Racor unión recta en reducción tubo - tubo

Acero Inoxidable AISI 316-L-1.4404

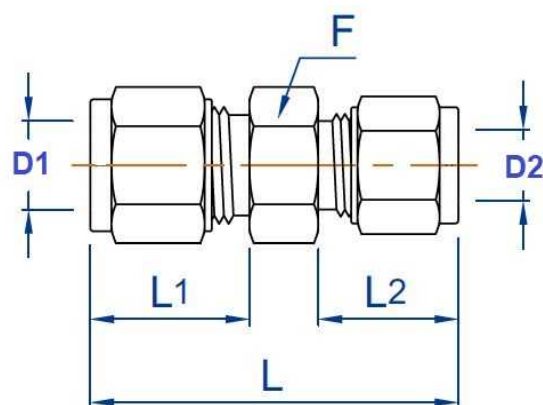

| Artículo | ØD1 | ØD2 | Ø int | L | L1 | L2 | F |
|-----------|-------|------|-------|------|-------|-------|--------|
| ZKI0402 | 1/4" | 1/8" | 2.29 | 38,6 | 24,63 | 17,8 | 1/2" |
| ZKI0504 | 5/16" | 1/4" | 5.08 | 42.4 | 27,4 | 18,5 | 9/16" |
| ZKI0604 | 3/8" | 1/4" | 5.08 | 43.3 | 28,72 | 19,3 | 5/8" |
| ZKI0804 | 1/2" | 1/4" | 5.08 | 47 | 29,5 | 22,1 | 13/16" |
| ZKI0806 | 1/2" | 3/8" | 7.11 | 48.5 | 30,99 | 22,01 | 13/16" |
| ZKI1006 | 5/8" | 3/8" | 7.11 | 49.3 | 31,7 | 22,1 | 15/16" |
| ZKI1008 | 5/8" | 1/2" | 10.41 | 52.1 | 31,7 | 22,1 | 15/16" |
| ZKI1204 | 3/4" | 1/4" | 5.08 | 49.5 | 31,7 | 22,1 | 1"1/16 |
| ZKI1206 | 3/4" | 3/8" | 7.11 | 50.8 | 33,3 | 22,1 | 1"1/16 |
| ZKI1208 | 3/4" | 1/2" | 10.41 | 52.1 | 33,27 | 22,01 | 1"1/16 |
| ZKI1608 | 1" | 1/2" | 10.4 | 60.7 | 38,1 | 26,7 | 1"3/8 |
| ZKI1612 | 1" | 3/4" | 15.49 | 60.7 | 38,1 | 26,67 | 1"3/8 |
| ZKI06M03M | 6 | 3 | 5 | 42.4 | 18,6 | 17,7 | 15 |
| ZKI08M06M | 8 | 6 | 5 | 42,4 | 18,6 | 17,7 | 15 |
| ZKI10M08M | 10 | 8 | 6.5 | 44,5 | 19,5 | 18,6 | 18 |
| ZKI12M10M | 12 | 10 | 7.9 | 48,7 | 22 | 19,5 | 22 |
| ZKI16M12M | 16 | 12 | 9.5 | 52 | 22 | 22 | 24 |
| ZKI18M12M | 18 | 12 | 9.5 | 53,5 | 22 | 22 | 27 |
| ZKI25M20M | 25 | 20 | 16 | 62,3 | 26,5 | 22 | 35 |